

Kitchen & Dining

Jar & Bottle Openers	598 - 599
Tin, Jar & Bottle Openers	600
Food Preparation	601 - 603
Homecraft Kitchen Utensils	604
Dycem® Non-Slip Solutions	605 - 606
Cutlery	607 - 617
Cutlery Aids	618 - 619
Plate Surrounds & Plates	620
Plates & Dishes	621 - 622
Cups & Mugs	623 - 629
The Hydrant Drinking System	630
Straws	631
Feeding Evaluation Kit	632
Kettles, Tippers & Holders	633 - 634
Bibs	635 - 636
Trays	637
Trolleys	638 - 640



1 6-in-1 Multi Opener

This Multi Opener has a durable and comfortable grip and opens six different types of seals and lids with ease. The unique tool removes hard-to-grasp safety seals, opens metal bottle caps, can ring pulls, and stubborn jar lids or bottle tops. The unique enclosed blade feature cleanly slices open tightly sealed bags. Weight 99g.

091168699



2 Homecraft Mighty Lever Jar and Bottle Opener

The flexible stainless steel band is fitted around a lid, and then clamped tight using the screw at the end of the handle. The handle can then be used as a lever. Suitable for tops 20 to 110mm (3/4 to 4 1/2") diameter. Weight 88g.

081501329



3 Homecraft Undo-It Jar and Bottle Opener

A V-shaped coated metal opener with non-slip lining that is screwed underneath a shelf or cupboard. The jar is slid into the V until the lid wedges. It is then twisted to remove the lid. Suitable for tops 25 to 75mm (1 to 3") diameter. Measures 140x100mm. Fixings not included. Weight 145g.

091096023 Retail Packed



RETAIL PACKAGED
These products are supplied in retail packaging.

1 Homecraft Twister Jar Opener

A cone shaped rubber moulding with fluted finger grips on the outside, and ribbing on the inside to give a good grip for opening twist-off jar lids. Suitable for tops 20 to 85mm (3/4 to 3 1/2") diameter. Weight 100g.

091095926 Retail Packed

091095918 Non Retail



homecraft

2 Homecraft Bottle Opener and Knob Turner

Flexible rubber moulding for an easy, firm grip on small tops e.g. drink bottles or medicine containers. Also excellent for turning knobs. Suitable for tops up to 35mm (1 1/2") diameter. Weight 85g.

091096122 Retail Packed



homecraft

3 Dycem® Jar Opener

Dycem's non-slip jar opener is another everyday essential from Dycem's non-slip range. Simple yet extremely effective, the jar opener provides a tighter, more thorough grip and makes stubborn jar lids a thing of the past. Soft and malleable, the jar opener is cone shaped so it fits perfectly into the palm of your hand. Dycem jar openers can also be used in conjunction with a non-slip mat for one handed opening of jars.

091095983 **A** Blue

091202613 **B** Silver



4 Dycem® Bottle Opener

Dycem's non-slip bottle opener is an everyday essential from Dycem's nonslip range. The dome shaped bottle opener fits comfortably in the palm of your hand and is soft and malleable for added comfort. Unique grip bars on the sides maximise your grip and enable you to effortlessly unscrew even the toughest bottle lids.

091095991 Yellow



LATEX FREE



LATEX FREE

A

B



LATEX FREE



INFORMATION

For our full range of Dycem products, please see pages 660 to 664.



RETAIL PACKAGED

These products are supplied in retail packaging.



1 New Improved One Touch Can Opener

A faster way to open cans of all types and sizes. The new improved One Touch can opener has been redesigned with several improvements to the original One Touch Can opener. The opener is suitable for all types of cans including large pie cans and corned beef style cans.

- Cuts all sizes and shapes above 52mm
- Easier to use, clean and replace batteries
- 50% faster cutting time over Original One Touch Can opener
- Battery life of 100 cans vs Original 80
- Available in Classic or Comfort grip models

091535681

2 Canpull™ Featuring Sodasnap

The Canpull is a durable device especially designed for opening ring pull cans. Extremely easy to use, just hook the end under the ring, fold forwards and then roll back. Suitable for users either with arthritis or with a weak grip. Stores easily on a hook or in the cutlery drawer. Also features a sodasnap, which has been designed specifically for opening the ring pulls on cans of drink. Dishwasher safe.

091096221



3 Spillnot Jar and Bottle Opener

This jar and bottle opener has three sunken cones of different sizes, lined with a non-slip material. When a jar or bottle is pressed in the appropriate cone, it is gripped, leaving both hands free to twist the lid. Can be used in conjunction with certain openers. Fitted with four non-slip feet.

Suitable for tops 44 to 108mm (1 3/4 to 4 1/4") diameter. Base measures 250x170x100mm. Weight 540g.

081015247

4 Homecraft Belliclamp Jar and Bottle Holder

This device hooks over the edge of a worktop and the jar or bottle is then placed in the V. The object is clamped by the ram, which can be pushed with the stomach or hip, leaving hands free to twist the top. The device is made of moulded plastic with non-slip feet and rubber lining. Can be used with most jar or bottle openers. Suitable for items up to 120mm (4 3/4") diameter. Measures 330x190x90mm. Weight 580g. Latex free.

091096148

5 Multi-Opener

A handy, multi-functional opener for bottle caps, screw tops and ring pulls. The handle provides great leverage for opening screw-on bottle tops. Ring pull seals are easily broken by inserting the ring into the end of the opener and lifting. On the same end is a bottle cap opener. The notch on the underside of the opener can be used to break the seal on twist off jar lids to make opening easier. The coloured parts of the opener are a non-slip material to prevent the users grip on the handle from slipping and to secure the opener onto the bottle top. Latex free. Weight 42g.

091096080



6 Baby Boa

A versatile device that can be used to assist with turning or opening in hundreds of instances, inside or out. Gives an excellent grip on any item from 10 to 100mm (1/2 to 4") in diameter. Simply place the loop over the item, pull the tail until tight and then turn in the direction of the arrow. Weight 72g.

091095934



homecraft



DISHWASHER SAFE

This product is suitable for use in a dishwasher.



RETAIL PACKAGED

These products are supplied in retail packaging.



1 Homecraft Stainless Steel Cooking Basket

This stainless steel basket allows vegetables to be cooked and strained without ever lifting a pan full of boiling water. The large flame retardant moulded nylon handle is easy to grip and provides heat insulation. Diameter 165mm (6½") at the top, tapering to 120mm (4½") at the bottom. Depth 90mm (3½"). Weight 245g.

091096890 165mm (6½") Retail Packed



2 Homecraft Peeler and Clamp

This handy device clamps to a table or worktop and enables fruit and vegetables to be peeled using only one hand. Clamped to the work surface by a sliding mechanism, the hardened, swivelling blade is slotted into the top. It is operated by holding the vegetable and pushing it over the blade, away from the user. The peelings then drop onto a plate placed behind the peeler. Suitable for work surfaces 12 to 55mm (½ to 2¼") thick. Measures 260×190×170mm. Weight 510g.

081305762



RETAIL PACKAGED

These products are supplied in retail packaging.



SPARES

Spares are available for this product, for details and full spares listing please contact Customer Services.



PRICES

For up-to-date prices please see our Website, alternatively contact your Sales Representative or Customer Services.



homecraft

1 Homecraft Kitchen Workstation

This multi-function food preparation unit is designed to provide assistance with many day-to-day kitchen tasks.

Based around a tough, durable chopping board measuring 500×300mm (19³/₄×11³/₄") the workstation also features:

- A removable grater and slicer (with a protective cover) that collects the food with a minimum of mess and waste.
- A raised L shaped corner measuring 130×95mm (5¹/₄×3³/₄") which can be used to hold bread and toast in place whilst it is being spread.
- Removable stainless steel spikes that secure bread, fruit or vegetables in place whilst being sliced, chopped or peeled.
- A removable clamp that can open up to 110mm (4¹/₄") wide and hold any object in place such as a bowl, a tin, bread, vegetables etc. The clamp has a reversible edge, allowing it to be either flat or contoured.

The workstation has four non-slip suction pads that firmly anchor it in place. Dishwasher safe.

081112259



2 Etac® Food Preparation System

This durable cutting board is ideal for those who have difficulty in gripping, or only have the use of one hand. The clamp can fix items such as tins or bowls, and the stainless steel spikes keep vegetables still when peeling or cutting.

It has four non-slip rubber feet to prevent the board from moving. Suction pads are also provided for use on wet surfaces.

Size 315×295mm (12²/₅×11³/₅"). Weight 1.66kg.

091096643



3 Homecraft Clyde Grater, Scraper and Spike

The white epoxy coated steel frame has a grating unit fitted to it with a plated metal mesh blade, for peeling or grating.

The top section is easily detached for cleaning. A stainless steel spike attachment is included for holding vegetables while peeling them with a manual peeler.

Measures 200×230×70mm. Weight 534g.

091096312



etac®



homecraft

DISHWASHER SAFE
This product is suitable for use in a dishwasher.

RETAIL PACKAGED
These products are supplied in retail packaging.

SPARES
Spares are available for this product, for details and full spares listing please contact Customer Services.

1 Homecraft Bread Board

This hardwood board is fitted with non-slip feet and six stainless steel spikes to grip bread or vegetables, when cutting one handed. It also has an L-shaped lip in one corner to allow one handed spreading of the cut slices.
Size 325×175mm (12¾×7"). Weight 972g.

091096635 Retail Packed



1



2 Homecraft Plastic Spread Board

A durable one-piece moulded board with raised L-shape in one corner. This allows bread to be spread using one hand.
Size 181×256mm (7⅛×10⅛"). Weight 190g.

091096742



2



3 Homecraft Plastic Spread Board with Spikes

This durable one-piece moulded board has a raised L-shape in one corner. This allows bread to be spread using one hand. It also features a set of six stainless steel spikes that can be inserted into the board. The spikes are designed to hold produce, such as bread or vegetables, firmly in place whilst they are being sliced or chopped.
Size 181×256mm (7⅛×10⅛"). Weight 190g.

081569623

091096767 Spare Set of Spikes



3

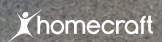

4 Chopping Board

A white polypropylene chopping board, 300×300mm (12×12"). Stainless steel spikes hold food in place for peeling or slicing. 12mm (½") high corner guards prevent bread from moving when having butter or margarine spread on it. Four suction cups anchor the board securely to the work surface.

091096684

5 Combination Chopping Board

A white polypropylene chopping board, 400×300mm (16 x 12") with a chef's knife attached. The knife has a 185mm (7¼") stainless steel blade and a black plastic handle. It can be removed for cleaning and sharpening. Three stainless steel spikes secure objects for peeling or slicing. 12mm (½") high corner guards prevent bread from moving when having butter or margarine spread on it.

091096700



4

5

RETAIL PACKAGED
These products are supplied in retail packaging.

SPARES
Spares are available for this product, for details and full spares listing please contact Customer Services.



1 Homecraft Reflex Kitchen Utensils

The Reflex range of kitchen utensils has an easy to grip contoured closed handle with the utensil set at an angle to minimise wrist movement for the user. The handle has been designed to counter balance the weight of the utensil whilst also being aesthetically pleasing. All the utensils are made from stainless steel and are all dishwasher safe.

A Homecraft Slicing Knife

Blade length 254mm (10"). Weight 125g.
081305804

B Homecraft Carving Knife

Blade length 203mm (8"). Weight 155g.
081305788

C Homecraft Chef's Knife

Blade length 203mm (8"). Weight 165g.
081305796

D Homecraft Preparation Knife

Blade length 127mm (5"). Weight 140g.
081305770

2 Homecraft Reflex Comfort Grip Utensils

This range of Reflex Comfort Grip Kitchen Utensils has been designed with a soft-touch overmoulded grip to provide a more comfortable slip resistant grip. The handle is set at an angle to minimise wrist movement when using the product and the grip is slightly larger than the standard range to reduce the amount of finger movement required to grip the handle. The utensils are available with the same stainless steel blades as in the standard Reflex range. Dishwasher safe.

A Homecraft Knife

This high quality stainless steel blade with a smooth sharp edge which is useful for cutting or chopping food. Blade length 205mm (8"). Weight 214g.
091207810

B Homecraft Carving Knife

This high quality stainless steel blade with a scalloped rather than a smooth blade which will stay permanently sharp. Blade length 205mm (8"). Weight 198g.
091207802

C Homecraft Slicing Knife

A high quality stainless steel blade that is long and narrow. Ideal for slicing bread. Blade length 254mm (10"). Weight 192g.
091207828

D Homecraft Preparation Knife

This knife has a scalloped edge and is useful for cutting and preparing food. The blade will not require sharpening. Blade length 127mm (5"). Weight 176g.
091207794

DISHWASHER SAFE
This product is suitable for use in a dishwasher.

RETAIL PACKAGED
These products are supplied in retail packaging.

SPARES
Spares are available for this product, for details and full spares listing please contact Customer Services.

Anchor your items onto any surface with Dycem Non-Slip's long-lasting non slip mats.

Dycem non-slip mats provide unbeatable grip for any item and have been proven to grip up to a 45 degree angle. Keep your things secure by using them on a range of surfaces.

These easy to use non-slip mats are antimicrobial, making them very hygienic. They are also made from non-toxic materials and do not contain any latex. These anti slip mats have so many uses that you will struggle to find a place that you can't use them. They are available in a range of sizes and colours.

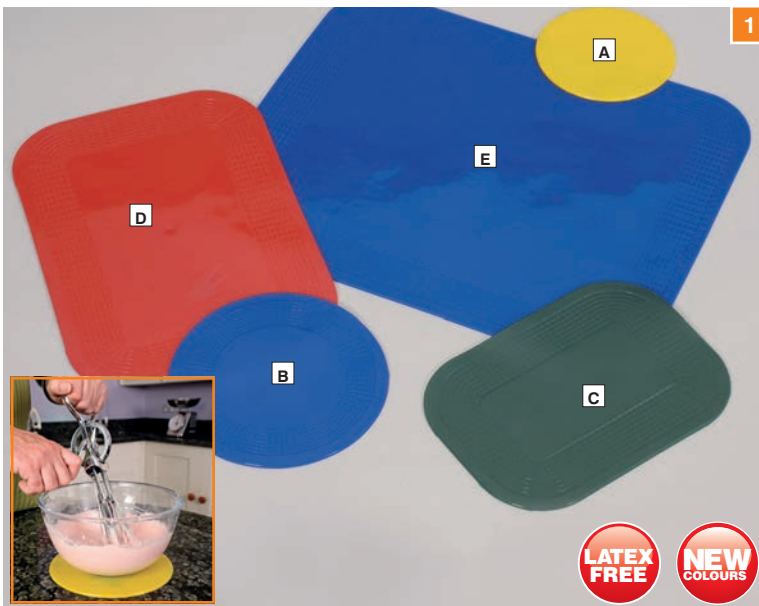

1 Dycem® Anchorpads

Size	Weight	● Blue	● Red	● Green	● Yellow	● Silver	● Lime	● Pink
A Round 140mm (5½")	74g	091102938	091102946	091102953	091102961	091102979	091565159	091565142
B Round 190mm (7½")	140g	091102987	091102995	091103001	091103019	091103027	091565175	091565167
C Rectangular 250×180mm (10×7½")	134g	091103035	091103043	091103050	091103068	091103076		
D Rectangular 350×250mm (14×10")	248g	091103084	091103092	091103100	091103118			
E Rectangular 380×450mm (15×18")	434g	091103126	091103134	091103142	091103159			

2 Dycem® Non-Slip Floor Mat

Dycem's non-slip floor mats are perfect for providing a sure footing, boosting mobility and helping with any balance issues. These mats are manufactured using Dycem's patented non-slip material, meaning that you won't get the unbeatable grip and stability anywhere else. Dycem's floor mats can help in lowering the risk of falls, and have been used by therapists to improve standing, sitting and positioning. Gain a sure footing with Dycem's non-slip floor mats. They measure 450×600mm (17¾×23¾") and available in Blue or Grey.

091102912 ● Blue
091102920 ● Grey

3 Dycem® Nose Over Toes Mat

This innovative floor mat is designed to provide better traction underfoot and to prompt the user to position their feet correctly and adopt an appropriate position when transferring in or out of a chair.

091535541



RETAIL PACKAGED
These products are supplied in retail packaging.



Dycem coloured reels are made from a non-woven fabric coated with non-slip properties. They can be used to cover large areas or cut to shape, especially suitable for moulding or wrapping around an object. The clear and check reels are made from a polythene base and are of a stiffer construction. They are more suitable for flat surfaces or when extra firmness is required.

1 Dycem® Reels									
Length×Width	Weight	○ White	● Blue	● Red	● Green	● Yellow	● Silver	● Lime	● Pink
1m×200mm (3'3"×8")	220g	091103530	091103548	091103555		091103571	091103589	091565316	
1m×400mm (3'3"×16")	410g	091103597	091103605	091103613	091103621	091103639	091103647	091565357	091565340
2m×200mm (6'6"×8")	344g	091103233	091103241	091103258	091103266	091103274	091103282	091565258	091565241
2m×400mm (6'6"×16")	592g	091103357	091103365	091103373	091103381	091103399	091103407	091565290	091565282
9m×200mm (29'5"×8")	990g	091103290	091103308	091103316	091103324	091103332		091565274	091565266
9m×400mm (29'5"×16")	2.1kg	091103472	091103480	091103498	091103506	091103514		091565332	091565324



CARDBOARD DISPENSER WITH 20cm BULK REEL

2 | Dycem® Non-Slip Bulk Reel Dispenser

This dispenser can sit on a table. The non-slip material has a protective film on both sides, which will keep the material clean until ready to dispense. The protective film also makes cutting easier – pull out the desired length, cut and peel film from both sides when ready to use. A smaller bulk roll is also available supplied in a card dispenser only.

- 091200021 Bulk Reel only 40cm×15m Blue
- 091200005 Bulk Reel supplied with Cardboard Dispenser 20cm×15m

3 | Dycem® Counter Top Display Units

These retail friendly product dispensers are ideal for sitting on the counter at the point of purchase. The units are available for the Dycem Jar and Bottle openers, and 14cm Anchorpads. All dispensers are supplied with 25 products stocked in them, ready to be put on display immediately.

- 091182260 Jar Opener Dispenser
- 091182278 Bottle Opener Dispenser



£ PRICES
For up-to-date prices please see our Website, alternatively contact your Sales Representative or Customer Services.



Homecraft Lightweight Foam Handled Cutlery

The Homecraft range of Lightweight Foam Handled Cutlery benefits from a comfortable design and is ideal for anyone with a weak or painful grip. The stainless steel utensils are sealed into light grey foam handles that are ribbed to make them easy to grip. The cutlery is suitable for hand wash use only but not suitable for use in a dishwasher. Handle diameter 28mm (1 1/4"). Handle length 115mm (4 1/2").

1 Standard Cutlery

The popular range of Standard Lightweight Foam Handled Cutlery is available individually or as a set.

- Not dishwasher safe, handwash only

		Weight
081305986	A Knife	45g
081305994	B Fork	34g
081306000	C Spoon	42g
081306018	D Teaspoon	30g
091098516	Retail Packed Set - 1 of each	151g



2 One Handed Cutlery

Mounted into a lightweight foam handle, can be used for one handed eating by combining cutlery functions.

- The splayed fork is a pronged fork with edges designed for cutting food and a deep rounded body which functions like a spoon
- The nelson knife is a knife with a cutting edge, which ends as a curved pronged fork, to enable food to be picked up
- The foam is comfortable to hold and washable (although not recommended for dishwashers)

		Weight
091098466	A Splayed Fork	40g
091098441	B Nelson Knife	45g

3 Angled Cutlery

Angled versions of the Lightweight Foam range for those with limited wrist or arm movement. The knife can be used without cocking the wrist and the fork and spoon are available as right (R) or left (L) handed versions. Knife blade at 90° angle. Fork and spoon at 40° angles. Stainless steel utensils with closed cell foam handles.

		Weight
081306034	A Knife	45g
091098540	B Right Handed Fork	40g
091098532	C Left Handed Fork	40g
091098565	D Right Handed Spoon	46g
091098557	E Left Handed Spoon	46g



RETAIL PACKAGED
These products are supplied in retail packaging.



**BEST
SELLER**



Homecraft Caring Cutlery

The Homecraft Caring Cutlery range is a set of stainless steel utensils moulded into contoured, plastic handles with built up ends. These are of value to those with a weak grip and restricted wrist or finger movement. The knives and forks have a shaped indent on the top for the index finger, to help with directional control. The knives also have a serrated blade to assist with cutting. The knife, fork, spoon and teaspoon are available as a set. Within the range there is an angled knife and left and right-angled forks and spoons that are designed to minimise wrist movement. The cutlery range is hygienically sealed, easy to clean and dishwasher safe. Length of handles 127mm (5").

1 Homecraft Standard Caring Cutlery

Available in Ivory or Black.

Ivory	Black		Weight
091098607	091535418	Knife	50g
091098623	091535426	Fork	50g
091098631	091535434	Spoon	60g
091098649	091535442	Teaspoon	45g
081533801	091535459	Retail Packed Set	215g



2 Homecraft Angled Caring Cutlery

These angled versions of the Caring fork and spoon are designed to minimise wrist movement. The utensils are hygienically sealed, easy to clean and dishwasher safe. Length of handles 127mm (5").

		Weight
091098672	A Right Handed Spoon	60g
091098698	B Right Handed Fork	50g
091098680	C Left Handed Fork	50g



3 Homecraft Soft Coated Caring Cutlery

These soft coated spoons have been dipped in soft, food quality PVC. They may be beneficial for users with bite reflex problems or a sensitive mouth. Due to the type of use to which these items are subjected, they are only guaranteed for three months. The spoons are hygienically sealed into the contoured Caring Cutlery handles, are easy to clean and dishwasher safe. Length of handles 127mm (5").

		Weight
091098656	A Soft Coated Spoon	65g
091098664	B Soft Coated Teaspoon	55g



4 Homecraft Junior Caring Cutlery

Designed primarily for children with a small utensil head.

- Easy to clean
- Dishwasher safe
- Stainless steel cutlery
- Length of handle 102mm (4")

Aqua	Sky Blue		Weight
091554864	091554898	Knife	24g
091554872	091554906	Fork	22g
091554880	091554914	Spoon	24g



RETAIL PACKAGED
These products are supplied in retail packaging.

DISHWASHER SAFE
This product is suitable for use in a dishwasher.



This range of stainless steel utensils are mounted into a lightweight ABS plastic built-up handle designed to help those with a weak or restricted grip. The handle is cylindrical with a slight taper away from the utensil with smooth contours to assist with gripping. All the items are hygienically sealed and are dishwasher safe. Length of handle 98mm (4⁵/₈"). Diameter of handle 30mm (1¹/₄").

1 Homecraft Queens Standard Cutlery

A popular range of standard utensils mounted in the Queens built-up handle.

- Available individually or as a retail packed set

		Weight
081305820	A Knife	45g
081305838	B Fork	45g
081305846	C Spoon	45g
081305853	D Junior Spoon	45g
091097427	E Teaspoon	45g
091097799	Queens Retail Packed Set including Knife, Fork, Spoon, and Junior Spoon (does not include teaspoon)	



2 Homecraft Queens Soft Coated Built-Up Spoons

These spoons have been dipped in soft, food quality PVC and then mounted into a built-up plastic handle for those with a weak or restricted grip.

- Beneficial for users with a bite reflex problem or a sensitive mouth
- Due to the type of use to which these items are subjected, they are guaranteed for 3 months only

		Weight
091097443	A Soft Coated Spoon	45g
091097435	B Soft Coated Teaspoon	50g



3 Homecraft Queens One Handed Built-Up Cutlery

These stainless steel utensils can be used for one-handed eating by combining cutlery functions.

- The splayed fork is a pronged fork with edges designed for cutting food and a deep rounded body, which functions like a spoon
- The nelson knife is a knife with a cutting edge, which ends as a curved pronged fork, to enable food to be picked up

		Weight
081305861	A Splayed Fork	45g
091097468	B Nelson Knife	55g



4 Homecraft Queens Angled Built-Up Cutlery

Stainless steel utensils with an angled head, enabling those with limited wrist movement to eat more easily.

- The fork and spoon are available as right or left handed versions

		Weight
081305879	Knife (not illustrated)	45g
081305895	A Right Handed Fork	45g
081305887	B Left Handed Fork	55g
081305911	C Right Handed Spoon	55g
081305903	D Left Handed Spoon	55g



RETAIL PACKAGED
These products are supplied in retail packaging.

DISHWASHER SAFE
This product is suitable for use in a dishwasher.



The Newstead Cutlery range has been ergonomically designed to give a soft, non-slip grip, the handles are cushioned to allow the user to hold the utensil firmly but comfortably, even when wet. The handles are made from tough plastic with a soft, flexible overmoulding allowing the handle to adapt to the user's grip. All the utensils are made from stainless steel. The handle's rounded shape allows it to fit naturally into the palm of a hand and is ideal for conditions such as Parkinson's disease, neurological impairments, arthritis or any condition that can cause poor grip. The entire range is latex free and dishwasher safe.

1 Homecraft Newstead Cutlery

The standard Newstead Cutlery range is available to purchase either individually or as a retail packed set of four.

		Weight
081610898	A Knife	80g
081610906	B Fork	80g
081610914	C Spoon	80g
081610922	D Teaspoon	80g
091097872	Set - Retail Packed	320g



2 Homecraft Newstead Angled Cutlery

Newstead Angled Cutlery is particularly suitable for those with limited wrist or arm movement.

- The knife can be used without cocking the wrist
- The forks and spoons are set at 40° but may be bent to a more suitable angle

		Weight
091097880	A Right Handed Fork	80g
091097898	B Right Handed Spoon	80g
091097906	C Left Handed Fork	80g
091097914	D Left Handed Spoon	80g
091097922	E Angled Knife	80g



3 Homecraft Newstead Weighted Cutlery

The splayed fork and the nelson knife are designed for one handed eating.

- The splayed fork combines a spoon and a fork into a one handed utensil
- The nelson knife is a knife with a cutting edge that ends as a curved pronged fork, enabling food to be picked up

		Weight
091097948	A Weighted Knife	130g
091097955	B Weighted Fork	130g
091097963	C Weighted Spoon	130g
091097971	D Weighted Teaspoon	130g
091097989	Set	520g



4 Homecraft Newstead One Handed Cutlery

Designed for one handed eating.

- The splayed fork combines a spoon and a fork into a one handed utensil. The nelson knife is a knife with a cutting edge that ends as a curved pronged fork, enabling food to be picked up

		Weight
091097997	A Splayed Fork	80g
091098003	B Nelson Knife	80g



RETAIL PACKAGED
These products are supplied in retail packaging.

DISHWASHER SAFE
This product is suitable for use in a dishwasher.

1 Sure Grip Cutlery

These stainless steel utensils have comfortable ribbed built up handles to assist people with a weak grasp. The rubber handles are 38mm (1½") wide and 102mm (4") long.

- 081287945** A Knife
- 081287937** B Fork
- 081287929** C Tablespoon
- 081287911** D Teaspoon
- 091058783** Set - one of each



2 Sure Grip Bendable Cutlery

The spoons and forks in this range feature a twist in the metal shaft to allow them to be bent to the desired angle.

- The utensils can be bent to either the right or left to the position that is the most comfortable for the user
- The knife has a curved rocker blade to allow the user to cut with minimal effort
- Comfortable 38mm (1½") wide built up ribbed rubber handles provide an improved grip

- 081288000** A Rocker Knife
- 081287994** B Fork
- 081287986** C Tablespoon
- 081287978** D Teaspoon
- 091058833** Set - one of each



3 Good Grips Cutlery

The forks and spoons have a special twist built into the metal shaft that allows them to be bent in any angle for either left or right handed use.

- Stainless steel utensils feature a 35mm (1⅜") diameter built-up handle
- Handle length 165mm (6½")

- 081339373** A Rocker Knife
- 081339381** B Serrated Rocker Knife
- 081339332** C Fork
- 081339357** D Tablespoon
- 081339340** E Teaspoon

Weighted utensils are available with 170g of extra weight in the built up handle to provide more control for people with a tremor or limited hand control. Weighted Serrated Rocker Knife is not available within the weighted utensils product family.

- 081339464** Weighted Rocker Knife
- 081339423** Weighted Fork
- 081339431** Weighted Teaspoon
- 081339449** Weighted Tablespoon



DISHWASHER SAFE
This product is suitable for use in a dishwasher.



PRICES
For up-to-date prices please see our Website, alternatively contact your Sales Representative or Customer Services.

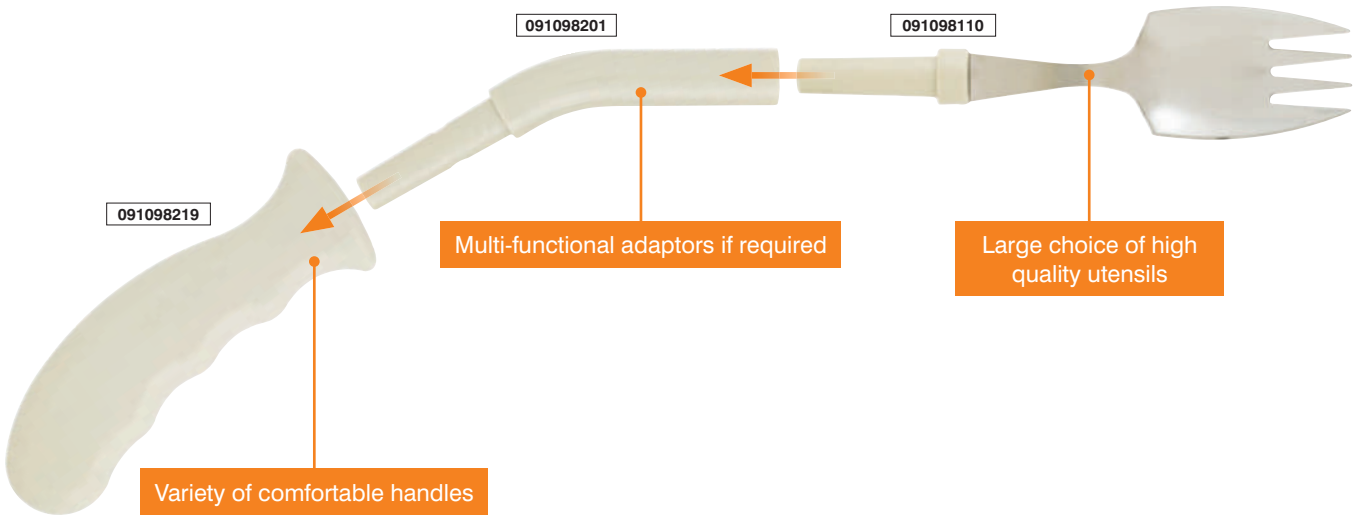

This attractive and comprehensive range allows a large amount of bespoke cutlery items to be made from 33 modular pieces.

It caters for virtually all needs – economically, visually, aesthetically and functionally. The range covers: standard, angled and specialised utensils; built up, slim, contoured, lightweight and heavyweight handles; and a unique double ended feature to create special utensils for one handed eating or to provide an inconspicuous hand strap. All items are hygienic, non-corroding and dishwasher safe.

See following pages for the selection of utensils, handles and accessories available in the range.

Assembly of Homecraft Kings Cutlery Range

To assemble a cutlery utensil and a handle, you simply push the utensil spigot into the hole in the handle. If the handle needs to be built up further, sleeves can be added. These must be fitted over the slim handle (091098300) first, and then the handle attached to the utensil spigot in the manner described above. If a double ended utensil is required, handles with a hole in both ends are available. The utensils can be rotated to the position required. When using the strap, it is placed between the handle and cutlery spigot or end piece.

1 Homecraft Kings Assessment Kit 33 Pieces

This kit contains one of each utensil, handle and sleeve, plus the Kings Button Hook. Ideal for assessing individual patient needs. Supplied in an attractive case with a specific place for each item.

081111970

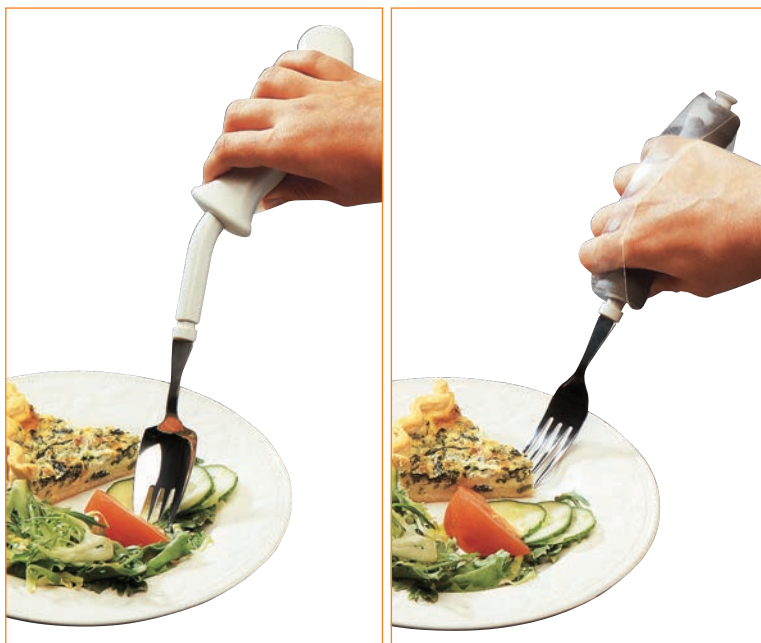

DISHWASHER SAFE

This product is suitable for use in a dishwasher.



SPARES

Spares are available for this product, for details and full spares listing please contact Customer Services.



1 Homecraft Kings Standard Cutlery Utensils

These standard utensils are mounted in plastic spigots that fit tightly into the chosen handle, but allow the blade to be angled as desired.

		Length	Weight
091097823	A Knife	112mm	17g
091097930	B Fork	104mm	21g
091098045	C Standard Spoon	97mm	23g
091098086	D Junior Spoon	91mm	21g
091098094	E Teaspoon	84mm	17g
091098102	F Soup Spoon	80mm	21g



2 Homecraft Kings Angled Cutlery Utensils

A range similar to the standard utensils but with angled blades for those with limited wrist or arm movement.

- Forks and spoons have left and right handed versions at 40° angles
- The angled adaptor adds extra length and a 30° angle to any utensil
- Knife is 52mm with 80mm offset at 90° angle

		Length	Weight
091098144	A Knife	132mm	20g
091098151	B Left Handed Fork	82mm	21g
091098169	C Right Handed Fork	82mm	21g
091098177	D Left Handed Spoon	82mm	23g
091098185	E Right Handed Spoon	82mm	23g
091098201	F Adaptor - Pack of 3	60mm	10g



3 Homecraft Kings Specialised Cutlery Utensils

The splayed fork (091098110) is a combined fork and spoon and the nelson knife is a combined knife and fork designed to help with one-handed eating.

- The small rocker knife is for cutting food with minimal rocking movement
- Can be used in double-ended cutlery handles to make one utensil more versatile
- The large rocker knife has a broad semi-circular blade ideal for preparing larger food without cocking the wrist

		Length	Weight
091098110	A Splayed Fork	82mm	22g
091098128	B Nelson Knife	110mm	25g
091098136	C Small Rocker	35mm	
		60mm width	19g
091098193	D Large Rocker	Max. width of blade 121mm	45g



4 Homecraft Kings Soft Coated Spoons

These spoons have been dipped in soft, food quality PVC.

- Beneficial for users with bite reflex problem when eating
- Due to the type of use to which these items are subjected, they are only guaranteed for three months

		Length	Weight
081112150	A Tablespoon	100mm	32g
091097815	B Teaspoon	80mm	25g



DISHWASHER SAFE
This product is suitable for use in a dishwasher.

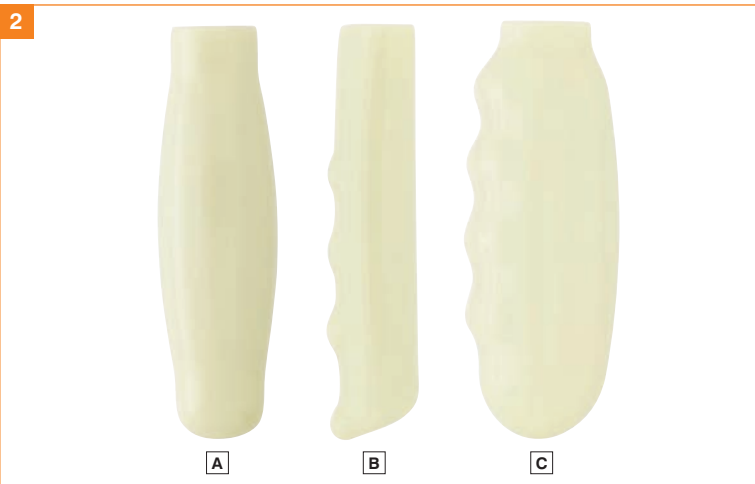

1 Homecraft Kings Standard Built-Up Handle

- Standard Handle has a hollow cylindrical body
- Slim has an oval cross section and this handle is also used as the core
- Contoured handle has a curved shape and finger contours
- The Mushroom is a round hollow doorknob type handle which is easy to grip for those with weak or painful joints
- Heavyweight Handle is similar to the standard, but the core is filled with a metal bar to make it heavier

		Width	Weight
091098227	A Standard	25mm	30g
091098300	B Slim	14-19mm	29g
091098219	C Contoured	22-30mm	85g
091098318	D Mushroom	65mm	52g
091098250	E Heavy Handle	25mm	156g



2 Homecraft Kings Built-Up Sleeves

Contoured PVC sleeves that fit over the slim handle 091098300.

		Width	Weight
091098326	A Oval Sleeve	23-30mm	24g
091098334	B Small Contoured	22mm	19g
091098409	C Large Contoured	29-35mm	38g



3 Homecraft Kings Lightweight Foam Handles

Made from grey sculptured closed cell foam for those unable to cope with the weight of standard built up handles. Washable.

		Width	Weight
091098243	A Small	20mm	10g
091098235	B Large	28mm	12g

4 Homecraft Kings Double Ended Handles with Strap

These are versions of the standard built-up and lightweight foam handles with utensil apertures in both ends.

- Supplied with a transparent adjustable strap and a fixing spigot that fits in the second hole
- A second utensil can be used e.g. the rocker knife 091098136 or angled knife 091098144 with or without the strap, to create versatile one handed cutlery
- Strap measurements 210x20mm (8x4/5")

		Width	Weight
091098268	A Standard	25mm	30g
091098284	B Lightweight	28mm	12g
091098276	Spare Straps - Pack of 10		



DISHWASHER SAFE

This product is suitable for use in a dishwasher.



SPARES

Spares are available for this product, for details and full spares listing please contact Customer Services.

1 Homecraft Nelson Knife

A stainless steel knife designed for one handed eating. The stainless steel knife blade can be used with a rocker action and the pronged end used as a fork. A built up sleeve from the Kings Modular cutlery range may be added to the handle. Handle length 100mm (4"). Weight 54g.

091098862 Retail Packed



2 Homecraft Splayed Fork with Slim Handle

A stainless steel combination utensil designed for one handed eating. This combined fork and spoon has side edges that have been shaped to give a cutting edge. A built up sleeve from the Kings Modular cutlery range may be added to the handle. Handle length 100mm (4"). Weight 34g.

091098847

3 Amefa Angled Contoured Cutlery

These items have shaped handles to assist those with restricted wrist or finger movement. The knife has a straight built up handle with angled blade that allows cutting with a rocker action. The forks and spoons have curved built up handles that are comfortable to grip and require little wrist movement. The stainless steel utensils are easy to clean and dishwasher safe. Length of handles 114mm (4 1/2").

Weight

- 091098730** **A** Knife 75g
- 091098755** **B** Angled Knife 78g
- 091098763** **C** Left Fork 48g
- 091098771** **D** Right Fork 48g
- 091098789** **E** Left Spoon 54g
- 091098797** **F** Right Spoon 54g



4 Etac® Light Cutlery with Thick Handles

These stainless steel utensils have an ergonomically designed ABS plastic handle and are intended for people with joint problems such as arthritis. The thick, light handles are easy to grip making the cutlery kind to the joints and relieve the strain on the fingers. The knife has a sharp curved blade to aid with cutting and the spoon has a deep bowl to reduce spillage.

Length Weight

- 091157379** **A** Fork 180mm 27g
- 091157387** **B** Knife 210mm 23g
- 091157395** **C** Teaspoon 180mm 30g
- 091157403** **D** Dessert Spoon 220mm 37g



DISHWASHER SAFE
This product is suitable for use in a dishwasher.

RETAIL PACKAGED
These products are supplied in retail packaging.



1 Knork™ Knife & Fork Combination

The Knork™ is a stylish fork with wide, rounded and bevelled outer tines that will safely cut food like a knife, without a sharp edge to cut the mouth of the user. It slices through food with a rocking motion which is facilitated by a finger platform on both sides of the handle. As it is symmetrical it can be used by both left and right handed users.

091177856

2 Unbreakable Utensils

Tough nylon material that is kind to lips and teeth - durable enough to be used by individuals with strong bite reflexes. The utensils can be customised for the user's need by cutting to shape with scissors and smoothing with an emery board. Can be cleaned in a dishwasher up to 80°C (180°F) and sterilised. Pack of 10.

081002708 Teaspoons

081002716 Soup Spoons

3 Flexible Cutlery

These versatile utensils may be angled or positioned in a variety of directions and wrap easily around the hand and/or wrist to secure in the position required. The foam handle is 25mm (1") in diameter. Includes a 250mm (10") Velcro® hook and loop strap that can be used to further secure the utensil on the hand. Each utensil weighs only 113g and measures 356mm (14") long. Dishwasher safe to 50°C (120°F).

081002799 Fork

081002807 Teaspoon

081002815 Tablespoon

081002849 Paediatric Spoon

(Not shown for illustrative purposes)

4 Plastisol™ Coated Spoons

Plastic coated spoons that provide protection for teeth and lips from utensil edges and temperature sensitivity. Not recommended for those with heavy biting reflexes. Dishwasher safe up to 80°C (180°F). Cold water washing prolongs life of the utensil.

One spoon supplied only.

081002625 **A** Long Teaspoon

081002617 **B** Tablespoon

081002666 **C** Teaspoon

5 Rocking T Knife

This rocker knife has a large, 100mm (4") handle with a stainless-steel, single-edged blade. Because pressure is applied directly above the food to be cut, less strength and dexterity is needed by the user. Dishwasher safe up to 105°C (220°F).

081201243

6 Steady Spoon

This uniquely designed spoon allows those who could not ordinarily feed themselves to achieve independence. Five moving parts and counter weights keep the spoon level no matter what the users arm position or level of tremor. The hook and loop strap on the built up handle eliminates the need for strong grasp. The bowl is a standard teaspoon size.

Handle 140mm (5½") long, 32mm (1¼") diameter. Handle and bowl 240mm (9½") long. Strap 127mm (5") long. Weight 226g.

081002898

7 EasiEaters™ Curved Utensils

Lightweight and easy to grip plastic utensils that are angled to promote greater success with hand and mouth feeding. Built up handles make it easier to hold. Set includes fork and spoon. Dishwasher safe. Colour may vary. Handle length 76mm (3").

081004993 Right Handed Utensils

081005008 Left Handed Utensils



DISHWASHER SAFE

This product is suitable for use in a dishwasher.



1

Counterweight

Counterweights balance the food to control the effect of the hand movement

Stopper

Allows easy uptake of food by restraining the spoon angle

Spoon

Made from stainless steel

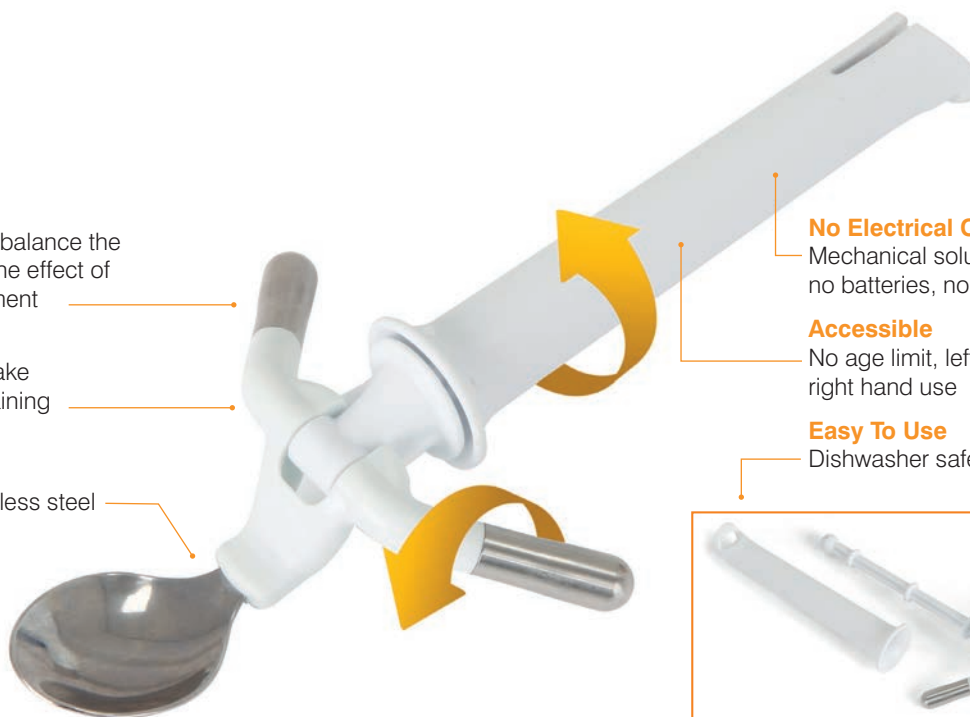

No Electrical Components

Mechanical solution, no batteries, no charge

Accessible

No age limit, left or right hand use

Easy To Use

Dishwasher safe



1 Elispoon Stabilising Spoon

ELISpoon is a revolutionary spoon that enables independent eating for people with hand coordination difficulties such as Cerebral Palsy, Essential tremors or Parkinson's disease. It is easy to use, to carry and to clean. Counter weights and rotation axes keep the spoon bowl level no matter what the adult or child's arm position or level of tremor, preventing food spillage. There are no electrical components or batteries.

- Counter weights keep the spoon level
- Easy to use and clean
- No electrical components or batteries
- Dishwasher Safe
- Length: 20 cm
- Width: 9.5 cm
- Weight: 70 g
- Colour: White
- Suitable for right and left handed

091566512



1



1

2 Maroon Spoon

Maroon spoons are ideal for narrow, shallow bowls made for feeding therapy. Spoons are perfect for poor lip closure, oral hypersensitivity, or tongue thrust. Not for severe bite reflex.

- 1 package contains 10 spoons
- Dishwasher safe up to 82°C
- No heated drying
- BPA free
- Phthalate free

081200427 Small 10/Pk
081200435 Large 10/Pk



2



DISHWASHER SAFE
This product is suitable for use in a dishwasher.



1 Thick Plastazote Foam Tubing

Closed cell foam tubing, available in various sizes to provide a built up handle for easier gripping e.g. cutlery, pens etc. It is non-absorbent, non-sticky, washable and dishwasher safe. Supplied in one metre (39") lengths, it may be cut to size. Exact lengths may vary plus or minus 50mm. External Diameter 31mm (1 1/4").

	Colour	Int. dia.	Weight
091101963	White	6mm	55g
091101971	Grey	6mm	55g
091101989	White	9mm	60g
091101997	Grey	9mm	60g
091102003	White	12mm	65g
091102011	Grey	12mm	65g
External Diameter 19mm (3/4")			
091101955	White	6mm	30g



2 Closed Cell Foam Tubing

Used for building up tool and utensil handles to give greater control to people who lack co-ordination, strength or gripping ability. Tubing has a slip resistant outer layer and is dishwasher safe. The tubing is 300mm (12") long and can be cut to the required length. Comes in packs of six. An assortment (two of each) is available for adults and children. The paediatric assortment comes in bright colours (Yellow, Orange and Blue). This is also suitable for the visually impaired.

081169713	Tan	Inner diameter 6mm (1/4") Outer diameter 22mm (7/8")
081169721	Red	Inner diameter 10mm (3/8") Outer diameter 28mm (1 1/8")
081169739	Blue	Inner diameter 16mm (5/8") Outer diameter 28mm (1 1/8")
091102037	Adult Assortment - 2 of each	
091102029	Paediatric Assortment - 2 of each	

3 Elastack™ Tapes

Elastack™ material is so soft, it seals out air on contact to form a suction bond. Adherence releases easily and is never sticky, making Elastack™ tapes ideal to prevent sliding and enhance grips. The ultra soft grade is the most adherent, transparent, and softest, but is not intended for use above room temperature. Medium grade is firmer, translucent, and durable at elevated temperature (dishwasher safe to 220°F/104°C). Tape is 20mm (4/5") wide and 3.6m (12') long. Latex free.

081204965	Ultra Soft Tape
081202118	Medium Soft Tape



DISHWASHER SAFE
This product is suitable for use in a dishwasher.

1 Cylindrical Foam Padding

This closed cell foam padding can be cut as required to build up items of cutlery. Supplied as a continuous length of foam padding (915mm). Dishwasher safe up to 180°C. Latex free.

	Colour	Internal Diameter	Outer Diameter
081169689	Light Blue	6mm (1/4")	19mm (3/4")
081169754	Blue	10mm (3/8")	35mm (1 3/8")



1

2 Homecraft Multi-Holder

Comfortable, easily adjustable, strap handle that provides a secure grasp on a variety of handle shapes and sizes. Made from a soft, stretchy fabric, this utensil securely holds a range of items such as cutlery, pens, pencils, brushes and combs. Useful for people with limited hand function or a weak grip. One size fits all. For left or right handed use. Colours may vary.

091098805

3 Weighted Utensil Holder

Easy to grasp utensil holder with a plastic cone shaped base that fits snugly into the palm of the hand. Designed to angle the utensil away from the palm to make eating easier. The hook and loop fastening enables the holder to be adjusted to fit most hands. The additional 226g weight within the base helps give stability for people with tremors. BPA and latex free.

081004159

4 Built-Up Utensil Holder

For those with poor hand function or a weak grip, this utensil holder has a half cone shaped plastic base, which angles the utensil away from the palm to make eating easier. May be used with cutlery, pens, etc. The hook and loop fastening enables the holder to be adjusted to fit most hands. BPA and latex free.

081004167



2



3

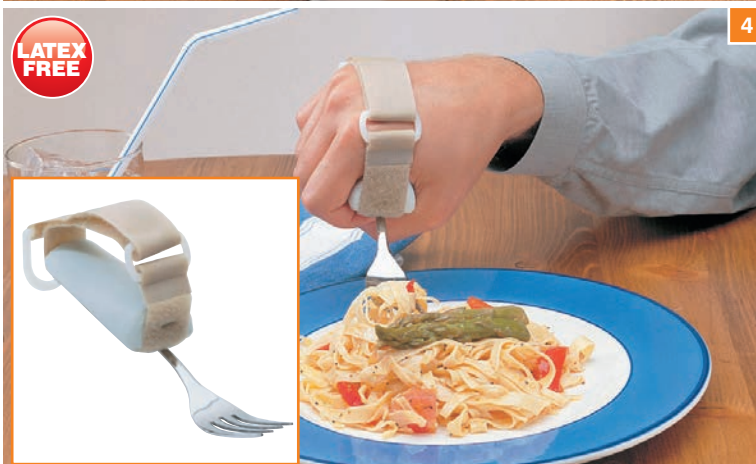

4



DISHWASHER SAFE
This product is suitable for use in a dishwasher.

1



homecraft

1 Homecraft Incurve Plate Surround

This flexible guard can be fitted to ordinary plates to assist with one handed eating. Three clips attach it to the rim and create a high inward sloping face to help with food collection and prevent spillage. Plate size 190 to 254mm (7½ to 10") external diameter. Microwave and dishwasher safe. Weight 45g.

091099167 Retail Packed

081306091 Non Retail



2



2 Invisible™ Plate Surround

This sturdy plastic ring is formed to snap easily onto a plate. The clear plastic is easy to keep clean. Dishwasher safe up to 50°C (125°F). Guard is 30mm (1¼") high. Large size fits plates 215 to 250mm (8½ to 10") external diameter. Small size fits plates 150 to 190mm (6 to 7½") external diameter.

081003110 Small

081003128 Large



3



**BEST
SELLER**



3 Medeci Plates

A deep dished plate to assist with picking up food. Made from tough plastic. The large contoured rim makes the plate easier to grip. It is lightweight, stackable and dishwasher safe. External diameter 241mm (9½"). Weight 180g.

091099043 Ivory

091099035 Blue



4 Manoy Contoured Plates

These melamine plates are designed to help those with one good hand or who have difficulty picking up food with utensils. They are oval in shape with a sloping bottom and high sided end to help scoop up food without spilling it over the side. Not suitable for microwave ovens, but dishwasher safe. Colours may vary.

Size

Weight

091098912 Small 227×159mm (8½×6¼") 200g

091098920 Large 279×197mm (11×7¾") 440g



4



**BEST
SELLER**

RETAIL PACKAGED

These products are supplied in retail packaging.

DISHWASHER SAFE

This product is suitable for use in a dishwasher.

INFORMATION

Differences between melamine and polypropylene:

Melamine

- Heavier weight plastic
- Break resistant
- Scratch resistant
- Stain resistant
- Not microwavable
- Dishwasher safe up to 80°C (180°F)

Polypropylene

- Lightweight plastic
- Unbreakable
- Can scratch
- Can stain
- Microwavable
- Dishwasher safe up to 80°C (180°F)

1 Suction Scoop Dish

Features three suction cups fixed on the base for maximum stability. Just moisten the suction cups and press to smooth, flat surface. Off white melamine with a heavy duty reinforced 229mm (9") rim and base. Provides stable, non-slip eating surface. Dishwasher safe up to 80°C (180°F). Not recommended for use with microwaves.

081004886**2 Scooper Plate**

This flat bottom plate has a high rim with a reverse curve on one side that helps in scooping food onto a spoon or fork without spilling over the side. Made from blue, heat resistant plastic, it has a non-slip detachable suction ring. Once the suction ring has been removed, the plate is dishwasher safe. Diameter 165mm (6 1/2").

081098888**3 Suction Scooper Bowl**

This 110mm (4 1/2") dish has a suction base attached. The curved rim guides food onto the spoon whilst the slip-resistant base helps keep the bowl firmly in place. Once the suction ring has been removed, the bowl is dishwasher safe. Colours may vary.

081005693**5 Hi-Lo Dish**

Users can push food onto cutlery against the vertical wall that surrounds half of this plate. The entry wall is at the lowest point and gradually slopes upward. Constructed of white polyester with non-slip feet on base. Dishwasher safe up to 80°C (180°F) and suitable for use in a microwave. 195mm (7 3/4") diameter. 13mm (1/2") to 45mm (1 3/4") lip height.

081146349**6 Keep Warm Dish**

Simply unlock the plug and fill the chamber with hot water to keep food warm for extended periods. Plastic funnel included. Top-rack dishwasher safe, but not suitable for the microwave. Measures 50mm (2") high x 200mm (8") diameter. 650ml capacity. Weight 900g. Comes with Lid. Colours may vary.

091438365 Adult Dish

RETAIL PACKAGED
These products are supplied in retail packaging.

DISHWASHER SAFE
This product is suitable for use in a dishwasher.



1 Plate with Inside Edge

The curved inside edge keeps food from sliding off the plate to make self-feeding easier for children or adults. Plate is 230mm (9") in diameter with a 25mm (1") rim and a 13mm (1/2") edge. Dishwasher safe up to 80°C (180°F) and microwave safe. Made from polypropylene.

081004670



2 Round Scoop Dish

Moulded low at the front and high at the back, this unbreakable, round scoop dish is especially useful for those eating with just one hand. Non-slip, rubber padded bottom provides control when using the scoop feature. 200mm (8") diameter. Washes in top shelf of domestic dishwashers. Not recommended for microwave use.

081005636 Yellow

081005644 Ivory

08111780 Red



3 Scoop Plate

Ideal for the one-handed user. The vertical wall guides food onto utensils. This lightweight polypropylene plate has a non-slip rubber-coated base to prevent sliding. Entry wall is 13mm (1/2") high and steadily increases upward to 38mm (1 1/2"). 230mm (9") diameter provides plenty of space for any size meal. This microwaveable plate has a 19mm (3/4") rim for easy handling. Dishwasher safe.

091098896 White

091098904 Blue



DISHWASHER SAFE

This product is suitable for use in a dishwasher.



INFORMATION

Differences between melamine and polypropylene:

Melamine

- Heavier weight plastic
- Break resistant
- Scratch resistant
- Stain resistant
- Not microwavable
- Dishwasher safe up to 80°C (180°F)

Polypropylene

- Lightweight plastic
- Unbreakable
- Can scratch
- Can stain
- Microwaveable
- Dishwasher safe up to 80°C (180°F)



1 Homecraft Caring Mug

This mug has a wide stable base with two large contoured and angled handles, which enables it to be held in the correct position for drinking. The lid has a well designed spout, and matches the Caring Cutlery range. It is useful for those with tremor or who cannot sit upright. The mug is suitable for use in a microwave and is dishwasher safe. Supplied with either a small aperture for liquids, or a large aperture for semi solids. Capacity 300ml (11fl.oz). Weight 176g.

	Aperture Size
091099563 Retail Packed	Small
091099555 Non Retail	Small
091165422 Non Retail	Large



1

Kitchen & Dining



1



1

SMALL APERTURE LID

LARGE APERTURE LID

RETAIL PACKAGED
These products are supplied in retail packaging.

DISHWASHER SAFE
This product is suitable for use in a dishwasher.

PRICES
For up-to-date prices please see our Website, alternatively contact your Sales Representative or Customer Services.



The Homecraft range of cups and mugs has been designed to aid independence and be suitable for a variety of needs, making them ideal for care home or home use.

1 Homecraft Feeding Cups

A range of clear plastic cups, designed for easy gripping. Two types of lid are available – a standard vented lid with a drinking spout or a lid with an adjustable spout that can be set vertical or clicked into an angled position. Both lids are available with either 4mm spouts for liquids or 8mm spouts for semi-solids/thickened liquids. The cups are supplied in pairs and are dishwasher safe up to 135°C (275°F).

	Spout Type	Aperture size	Capacity	Weight
091099977	Standard	4mm	250ml (9fl.oz)	80g
091099985	Standard	8mm	250ml (9fl.oz)	80g
091099993	Adjustable	4mm	250ml (9fl.oz)	100g
091100015	Adjustable	8mm	250ml (9fl.oz)	100g



2 Homecraft Clear Beakers with Holder

This beaker holder is made from toughened ABS plastic for extra strength and fits the **091099977**, **091099985**, **091099993** and **091100015** style of beakers. The beakers simply slot into the holder and are gripped in place providing a large easy to grip double handle. The wide rim base prevents beakers being easily knocked over. Each beaker holder is supplied with two mugs and two lids (4mm and 8mm spout). Dishwasher safe.

091421015 Beaker Holder & 2 Mugs Retail Packed



3 Homecraft Wing Handled Beaker

The large wing handles allow this beaker to be gripped in a comfortable position making it ideal for anyone with limited grip. Raised ridges prevent the mug slipping and consumption can be easily measured from the gradations on the side. The beakers are supplied as a pair with a narrow spout for liquids and wide spout for semi-solids. The beakers are dishwasher safe but the lids should be washed in warm water only.

091421007



RETAIL PACKAGED
These products are supplied in retail packaging.

DISHWASHER SAFE
This product is suitable for use in a dishwasher.



1 Homecraft Shatterproof Mug

This attractive mug is made from a tough, shatterproof material to prevent accidental breakage. The liquid consumption is easily measured by the marked gradations and the mug is supplied with a choice of lids. The spout lid helps with drinking and the recessed spill-proof lid avoids splashes. The mug is dishwasher safe and microwaveable, but the lids should be washed by hand. **081569656**



2 Homecraft Two Handled Mug and Lids

This popular mug has larger handles and shaped finger holds for ease of use. Gradations in the translucent material allow liquid consumption to be measured. The mug has a larger 270ml (9fl.oz) capacity. The lids supplied also fit the **081569656** shatterproof mug. Supplied as a pair with two lids – one spout lid and one splash lid. The mug is dishwasher safe, but lids should be cleaned in warm soapy water only. **091099571** Pair Retail Packed



3 Homecraft Wide Base Mug

This mug is made from high strength polycarbonate and has a wide base for stability to help prevent tipping. The dual handles provide a secure grip making it ideal for anyone who has a limited grasp. It also features visible gradations on the side so that liquid consumption can be easily measured. Available with either a white spouted lid or a clear spouted lid. An anti-splash lid is also supplied with the **091001262** mug. Capacity 285ml. Dishwasher safe.

091100049 Mug with Solid White Lid
091001262 Mug with Transparent Lid



1



2



3

 **RETAIL PACKAGED**
These products are supplied in retail packaging.

 **DISHWASHER SAFE**
This product is suitable for use in a dishwasher.



1 Sure Grip Mug

This feeding cup is designed with an angled spout to facilitate ease of use. Grooves in the cup ensure a better grip and the unique lid enables flow control and reduces spills if the cup is tipped over. Microwave and dishwasher safe up to 130°C degrees. Supplied with either a lid with a small aperture for liquids, or a large aperture for semi solids. A choice of colours is also available. Capacity 200ml (7fl.oz.).

Colour	Lid Aperture
091099589 Clear	Small
091099639 Clear	Large
091099647 Blue	Small
091099670 Yellow	Small
091099654 Green	Small
091099662 Pink	Small



2 Cup with Temperature Regulated Lid

This version of the Sure Grip mug above has a lid that changes colour when the contents are hotter than body temperature. If liquids hotter than 37½°C (96°F) are put into the beaker the lid will change colour from blue to pink, alerting the user to be careful when drinking. The lid is safe and easy to use and can also be used with a straw. Do not leave lid in direct sunlight.

091100114



3 Novo Cup

The Novo Cup is ideal for those who are in bed, lying down or have restricted head and neck movement. The 250ml cup is dishwasher and microwave safe. It is suitable for both hot and cold liquids. Once the lid is placed firmly on the cup and the stopper is in place, the cup becomes spill proof after the first sip.

091099498



4 Medeci System Cup

Available in three colours (suitable for the visually impaired) and able to be customised to individual needs. The handles can be inserted into fluted slots on the cup in the positions best suited to the user. Made from tough ABS plastic, the cups are microwaveable, dishwasher safe, stackable, hardwearing and versatile. Only available with a spout top lid. Capacity 340ml. (12fl.oz). Weight 170g.

- 091099704 Transparent Blue
- 091099712 Transparent Red
- 091099720 Ivory
- Accessories
- 091099688 **A** Spout Top



RETAIL PACKAGED
These products are supplied in retail packaging.

DISHWASHER SAFE
This product is suitable for use in a dishwasher.

1 Nosey Cutout Tumblers

These cups are designed for added comfort and convenience. A special cutout helps to maintain the proper head and neck positioning when swallowing, making drinking even easier. Each tumbler is transparent which enables monitoring of liquid intake. Durable polypropylene makes these tumblers dishwasher safe up to 109°C (228°F).

- 081003466** 115ml (4fl.oz)
- 081003391** 236ml (8fl.oz)
- 081003425** 340ml (12fl.oz)

2 Dysphagia Mug

The design of this cup helps prevent liquids from escaping at the lips and directs the liquid to the centre of the mouth. It provides sufficient nose clearance to empty the cup without tilting the head back. The extended handle accommodates gripping by the entire hand or by the thumb only. Dishwasher safe to 80°C (180°F). Not recommended for microwave use.

- 081290527** Almond
- 081290535** Green

3 Homecraft Deluxe Nosey Cup

This stylish cup is shaped to avoid contact with your nose when the cup is tipped allowing you to drink without tipping your head back. The material is tough polycarbonate which is shatterproof and resists cracking, prolonging the life of the cup. The ergonomic shape ensures that it sits comfortably in the hand, making it easy for those with limited grip. The cup is also available with a set of handles which clip into the inset rim around the edge of the cup helping those with limited vision and allowing a firmer two handed grip if necessary. Simply align the small lugs on the cup to the corresponding holes in the handle and press firmly into place. To remove the handles, gently twist each side in turn and pull down. Microwave safe and dishwasher safe up to 80°C. Capacity 250ml.

- 091536275** Deluxe Nosey Cup
- 091536283** Deluxe Nosey Cup with Handles
- 091536333** Spare Handle

4 Nosey Cutout Cup

Designed for use by people who have difficulty tipping their head back. The cup is notched to allow room for the nose when cup is tipped. Dishwasher safe. Capacity 237ml (8fl.oz). Weight 40g.

081290584

5 Ergonomic Nosey Cup

This ergonomic Nosey Cup provides a steadier grip with its contoured shape and a slightly textured surface. A special cutout for the nose area allows users to drink easily without tipping the head back. Translucent plastic lets the carer monitor liquid intake easily. Dishwasher safe up to 80°C (180°F).

081003516

6 Flexi Cups

These flexible cups with cut outs can be gently squeezed to change the shape of the cup lid. Liquid is visible through the plastic to aid with feeding. The green cup is stiffer and designed to be used independently. Dishwasher safe and latex free.

- 081200393** Pink Flexi Cups 30ml (1fl.oz.) Set of 5
- 081200401** Blue Flexi Cups 59ml (2fl.oz.) Set of 5
- 081200419** Green Flexi Cups 207ml (7fl.oz.) Set of 5

7 Handy Cup

This two handled transparent polycarbonate cup has an extra wide base that provides stability, reducing the possibility of accidental spills. The angled design allows a person to drink without having to tip their head back to drain the cup. It can also be tipped beyond the point where a normal cup would touch the bridge of the nose. The user requires little (or no) neck movement to be able to use the cup. Holds 237ml (8fl.oz.). Weight 112g. Dishwasher and microwave safe.

081112341



 **DISHWASHER SAFE**
These products are suitable for use in a dishwasher.

1



1 Easi 2 Drink Tumbler

This unique product aids those who have difficulty in drinking without spilling. It is particularly suitable for those who suffer from hand tremors, Parkinson's Disease and Multiple Sclerosis amongst other conditions. The plastic insert sits inside the tumbler and restricts the wave motion of the liquid helping reduce the possibility of spills. The inserts are made from ladene polyethylene and are dishwasher safe. The inserts can be easily removed for cleaning purposes. A stainless steel extractor for the insert is included. Tumbler is ceramic.

091099522 Easi 2 Drink Tumbler

091099530 Spare Insert



2



2 Etac® Clear Beaker and Holder

A clear, insulated beaker, which has a lid and spout to reduce spillage when drinking. The holder has a large handle and a supporting lip so that it can be held firmly using both hands. Dishwasher safe. Capacity 400ml (14fl.oz). Weight: Beaker 54g, holder 56g, lid with spout 13g.

091099480



3



3 Provale™ Regulating Cup

Created to preserve the dignity of those who suffer from dysphagia or disorders associated with difficulty swallowing. The Provale™ Cup can be filled at the beginning of the meal and the diner can drink at will, on their own. The cup delivers a measured amount of liquid (5ml or 10ml) to the drinker to prevent choking. The cup also allows cleanup to be limited to one piece of dinnerware rather than the several parts of other feeders. Optional one or two easy-grip handle or no handle design. Dishwasher safe.

081066471 5ml Dispenser Blue

081066489 10ml Dispenser Brown



4



4 Insulated Mug with Lid

This polypropylene mug has a large easy to grasp handle and insulates hot or cold liquids. A weighted cup is also available, which has an extra 225g (8oz) of weight to make it easier for patients with tremors and athetosis to control movement while drinking. Not recommended for dishwasher or microwave use. Capacity 340ml (12 fl oz).

081003300 Standard Cup

081003094 Weighted Cup

 **RETAIL PACKAGED**

These products are supplied in retail packaging.

 **DISHWASHER SAFE**

This product is suitable for use in a dishwasher.

1 Vital Cup

Drink with ease – even in bed. The Vital Cup is designed for anyone who has a limited range of motion of the neck and can be used when lying in bed. Its unique design enables you to drink comfortably and independently due to the cone shaped interior cup. The contents of the cup can be emptied completely and easily without having to tip the cup. The Vital Cup is microwaveable and dishwasher safe. Height 115mm. Weight 140g. Diameter 71mm. Capacity 200ml.

091530799 Red



2 RiJe Dysphagia Cup

The RiJe Dysphagia Cup is designed for people suffering with difficulty swallowing or requiring pre-determined dose of liquid. It is also ideal if you have a limited range of head, neck and arm movement. The portion size can be pre-set to any size from 3ml to 15ml to provide and accurate consistent delivery. The cup automatically dispenses a limited portion of liquid each time it stands in its upright position. Once the portion is withdrawn and the cup is placed in an upright position again, it delivers another portion within 2-3 seconds. The RiJe Cup benefits from large ergonomic handles for a secure grip and a good nose cut for easy drinking without tilting your head back. It can be used with water like or light nectar thickened liquids (approximately the viscosity of maple syrup). Dishwasher safe to 180°F and suitable for use with warm and cold drinks.

081615178



3 Cup with Built-In Straw

For adults or children who need to drink with a straw, the cup eliminates the need to continuously buy extra straws. The straw reaches the liquid at the bottom of the cup to prevent air ingestion. BPA and Phthalates free. Holds 370ml.

081112523



1



2



3

DISHWASHER SAFE
This product is suitable for use in a dishwasher.

SammonsPreston

1



1 The Hydrant Drinking System

The award-winning Hydrant assists in the prevention of dehydration, which is a big problem within healthcare, and in turn can create other health problems, e.g. constipation, urinary tract infections, dizziness, bed sores and blood pressure problems. Where people are bed bound or have limited mobility, the risk of dehydration is increased, as they are dependent on someone else to help them access fluids. The Hydrant eliminates this problem, with its ability to hook, clip or hang onto beds, wheelchairs, chairs, belts, and with its long drinking tube to assist the user.

With its integrated cap and hanging bracket, the Hydrant has a drinking tube with a bite valve and a small clip to attach the tube to clothing if required. When the bottle is hung from a bed, chair, or wheelchair, the user simply takes hold of the tube, inserts the bite valve between their lips, then bites and sucks it to access the fluid. This ensures there are no leaks, spills or drips. If hung above head height, the tube works as a siphon, helping those with limited sucking ability, as fluid gently flows when the valve is activated. It has an ergonomic handle and indentations for easy holding, even for users with a poor grip, Parkinson's, MS, Arthritis, etc. It also has gradations on the side to monitor fluid intake.

The Hydrant has become standard issue equipment in some hospitals and rehabilitation units.

Dishwasher safe.

091184084 Hydrant 1 litre Bottle with Tube

091203199 Spare Tube



1



1



1



DISHWASHER SAFE

This product is suitable for use in a dishwasher.

1 Kennedy™ Cup

This spill-proof cup is perfect when sitting or reclining. The easy-to-grip handle can be picked up by weaker hands and is suitable for right or left handed people. The lid screws on tightly to prevent leaks and accepts any standard disposable straw. This lightweight, durable cup holds 200ml (7fl.oz) of warm or cold liquid. Dishwasher safe to 80°C (180°F). Latex free. Height 11.5cm (4½").

081003821



1

2 Sip-Tip Drinking Cup

The Sip-Tip valve helps straws stay full of fluid, reducing the amount of air ingested and effort required. The one-way valve can be trimmed at designated areas, giving the user selective flow restriction. Valve and lid are compatible with most brands of disposable flex straws. The spill-resistant tumbler has a graduated scale to monitor intake. Not recommended for carbonated beverages. Microwave and dishwasher safe to 82°C (180°F). Latex free.

081204148 Sip-Tip Drinking Cup with Lid, One-way Valve and 10 Straws



2

3 One-Way Drinking Straws

These straws have one-way valves which stay filled with fluid, even after removing the straw from a user's lips. This feature eliminates the possibility of sucking in too much air while drinking. The clip-on straw hooks onto the side of a glass or cup to prevent the straw falling out. Each package contains two straws, one 254mm (10") and one 178mm (7"). Latex free.

091438357

4 Re-Usable Drinking Straws

These 457mm (18") straws come in two varieties: flexible and rigid. The 5mm (3/16") and 6mm (1/4") diameter, rigid straw can be heated with a heat gun and reshaped as desired. The rigid straw is ideal for soups. The flexible polyethylene straw comes with a 5mm (3/16") diameter hole. Latex free.

	Type	Diameter	Pack Size
081003284	Flexible	5mm	10
081003292	Rigid	6mm	5



3



4



DISHWASHER SAFE
This product is suitable for use in a dishwasher.



Homecraft Adult Feeding Evaluation Kit

This kit contains a variety of special eating utensils selected to help explore and solve the problems that delay or prevent self-feeding. The items included represent most areas of need. The kit is in a handy carry case for convenience and includes:

- | | | | |
|---------------------|--------------------------------------|---------------------|--------------------------------|
| 1 091098607 | Caring Cutlery Knife | 15 081306091 | Incurve Plate Surround |
| 2 091098623 | Caring Cutlery Fork | 16 081005636 | Round Scoop Dish |
| 3 081287986 | Bendable Tablespoon | 17 081005693 | Scoop Bowl |
| 4 081288000 | Bendable Rocker Knife | 18 091098920 | Manoy Contoured Plate |
| 5 081305986 | Lightweight Foam Handle Knife | 19 081004670 | Plate with Inside Edge |
| 6 091098532 | Lightweight Foam Handle Left Fork | 20 081569656 | Shatterproof Mug with Two Lids |
| 7 091098565 | Lightweight Foam Handle Right Spoon | 21 091099555 | Caring Mug - Bulk Pack |
| 8 081305861 | Queens Splayed Fork | 22 091099589 | Non-Spill Cup |
| 9 091097468 | Queens Nelson Knife | 23 081003391 | Nosey Cutout Tumbler - 236ml |
| 10 091098805 | Multi-Holder | 24 091102987 | Dycem Anchorpad - 190mm Blue |
| 11 081002815 | Flexible Handled Tablespoon | 25 091103241 | Dycem Grippistrip - 2m Blue |
| 12 081000462 | Sure Hand Strap | | |
| 13 081201243 | Rocking T-Knife | | |
| 14 091102037 | Closed Cell Foam Tubing - Adult pack | | |

091099175 Adult Feeding Evaluation Kit

1 Cordless Electric Mini Jug Kettle

A miniature kettle, ideal for boiling small amounts of water. It has an automatic cut out switch and the base can be fixed down, with provision for screws. It is extremely light and easy to lift compared to standard kettles and is ideal when travelling. The kettle can be easily lifted from the base providing maximum freedom of movement when filling or pouring.

Size 190mm×125×205mm. Capacity 800ml. Weight 0.6kg.

091100239

2 Homecraft Long Handled Bottle Holder

This long handled wire frame is used to carry bottles easily and safely without having to bend to pick them up, leaving a hand free for support. Handle length 600mm (24").

Max bottle diameter 83mm (3¼"). Weight 610g.

091096916

3 Derby Kettle and Teapot Tipper

This tipper allows the safe and steady pouring of hot liquids without lifting any weight. The Teapot Tipper is designed to assist those who have problems with physical tremors or have difficulty in pouring. It is suitable for most types of teapots or electric kettles and comes with a Velcro® hook and loop strap for added security. Made completely from plastic it is lightweight and corrosion resistant. Suitable for use with cordless kettles. Length 205mm (8"). Width 275mm (11"). Height 200mm (8"). Weight 500g. When using the tipper with a cordless kettle (especially a jug kettle) for additional safety, it is recommended that the Tipper Stabiliser Base is used.

091100163 Kettle Tipper

091100171 Stabiliser Base



1



2

homecraft



3

KETTLE TIPPER



3

STABILISER BASE

1



1 Homecraft Universal Kettle Tipper

This innovative kettle tipper is designed to be compatible with most kettle types including standard, jug and cordless kettles. The lever can be positioned on either side of the tipper to tip the kettle while it is held in place, without the user having to actually lift the water. This reduces the effort required and potential strain on the wrist that can occur when holding the kettle handle. For added safety the kettle will rock back into the upright position if the user lets go during use. The base plate is 200mm in diameter and has a sliding stop at the front so that the kettle can be positioned in the most suitable position. It is then secured in place by the two sturdy straps. The tipper is manufactured from attractive heat resistant plastic for durability and has rubber feet to prevent sliding on the work surface.

091207281



2 Homecraft Cordless Kettle Tipper

This innovative kettle tipper will suit most cordless kettles. There is a metal plate that secures the base of the cordless kettle and a frame with a hook and loop strap to keep the upper part of the kettle in place. A cut out at the foot of the tipper allows cups to be positioned as close to the kettle as required. The frame has a built in back stop to prevent spillage if the kettle is accidentally released during use. Weight 1kg.

091100148



2



RETAIL PACKAGED

These products are supplied in retail packaging.



SPARES

Spares are available for this product, for details and full spares listing please contact Customer Services.

1 Disposable Bibs

Convenient, lightweight, throw away clothes protectors that comfortably tie behind the neck, with a 100mm (4") trough to prevent runoff. Sold in packs of 50. Bib size 457x406mm (18x16").

081004233

2 Tabard Style Bibs

These tabard style clothes protectors are waterproof, absorbent and comfortable. The designs have a subtle, over-the-shoulder shape which provides the attractive and dignified look of a tabard but with a short back, making it an easy shape to put on and take off. The tabards have wide shoulder coverage and are shaped at the front to enable free arm movement at mealtimes. The long lasting snap fasteners are reinforced to ensure they stay firmly fixed in place allowing wide adjustment around the neck to suit most sizes or, alternatively, the tabards can be stretched over the head for convenience. Machine washable up to 80°C. Tumble drier proof.

Blue Burgundy
091158161 091558139 Small
091158179 – Medium
091534718 – Large

Size	Torso Length (L)	Shoulder Width (SW)	Body Width (BW)	Neck Circumference (C)
Small	430mm (17")	330-370mm (13-14½")	315mm (12½")	380-460mm (15-18")
Medium	560mm (22")	400-450cm (16-18")	380mm (15")	380-500mm (15-20")
Large	780mm (31")	420-490mm (16½-19")	380-460mm (15-18")	410-560mm (16-22")

3 Adult Neckerchiefs

These stylish Adult Neckerchiefs have a subtle and dignified look, are very soft to feel, absorb liquid instantly and are 100% waterproof. The Neckerchiefs are made from super-soft, lightweight fabrics throughout, which allow the bib to gather easily and comfortably around the neck. The gentle folds in the fabric help catch spills and give an attractive, neckerchief or scarf style look. The front fabric is absorbent, wicking away moisture helping to keep skin dry. It has a middle absorbent layer and waterproof back layer to offer total protection to clothes. The garment is quick fastening at the back of the neck. Machine washable at 40°C and suitable for use in a tumble drier. Width (across shoulders) 340mm (13"). Length (neck to bottom of garment) 200mm (8"). Neck circumference 400-500mm (15¾-19¾").

091534726 Navy Blue



NEW DESIGN

2

MACHINE WASHABLE



MACHINE WASHABLE

£ PRICES
 For up-to-date prices please see our Website, alternatively contact your Sales Representative or Customer Services.



1 Homecraft Everyday Bib

A smart and practical bib for everyday use. The colourfast polycotton outer is hard-wearing but absorbent. The soft, flexible waterproof backing ensures that clothes are not stained. All bibs are fitted with press studs so that a pocket can be formed to catch excess food if required. Bibs can be fastened either with hook and loop patches for quick, easy donning, or with metal poppers for extra security. There are two alternative fastening positions for the poppers. The bibs are fully washable and can be tumble dried at low temperatures.

Available in three sizes: Small 580×380mm (23×15"); Medium 680×460mm (26¾×18"); Large 890×460mm (35×18").

Blue	Red	Size
091421155	091421148	Small
091099399	091099407	Medium
091099365	091099373	Large



2 Homecraft Wipeclean Bib

A smart, practical bib that requires no washing. Both the upper polyester surface and the PVC backing can be wiped clean after use. Simply wipe with a damp cloth or a very mild bleach solution. The neck features hook and loop fastening for easy fitting and the long length of the bib offers excellent protection to users. Dimensions 890×460mm (35×18").

091421056



3 Homecraft Dining Bib

A full length, highly economical bib that offers all-over protection. Hook and loop fastening allows quick and easy donning. A soft waterproof backing prevents seepage whilst the hard-wearing polyester outer layer catches spills. Wash and iron on low heat only. Colours may vary according to availability. Dimensions 890×460mm (35×18").

091099332 Single Retail Packed



RETAIL PACKAGED
These products are supplied in retail packaging.



1 Homecraft Stay Tray with Bean Bag

The Stay Tray with bean bag sits comfortably on your lap in a stable position. It allows you to use the tray sitting on a chair or lying in bed, providing a firm base for eating, drinking or recreational activities. The tray is washable and comes with a detachable bean bag. The bean bag cover is also removable and can be machine washed. The tray is supplied with a non-slip, heat-resistant silicon mat to stop plates or cups from sliding. The mat colour may vary.

091100338



2 Homecraft Freehand Tray

The Freehand Tray range allows you to carry the tray and its contents with only one hand, allowing you to open doors, climb stairs and support yourself safely whilst carrying items. The unique handle folds flat inside the inner rim of the tray and locks into place in the upright position, ensuring your hands do not become trapped when you put the tray down. The handle can easily be removed if required, for cleaning or use as a standard tray.

The tray is available in three variations

Tray with Carry Handle

091100320

Freehand Tray with Non Slip Mat

A tray with a non-slip, heat-resistant silicon mat to stop plates or cups from sliding (mat colour may vary)

091100312

All in One Tray

An all in one tray with carry handle supplied with silicon mat to prevent items from slipping and a bean bag to allow the tray to also be used as a lap tray providing a stable surface.

091536267



3 Homecraft Adjustable Wooden Bed Tray

Attractive, practical wooden frame bed tray. Adjustable to five different angles for reading, writing, etc. The legs fold out to allow the tray to be placed comfortably across the lap. The tray is laminated to allow easy cleaning. Height 235mm (9 1/4"). Width 540mm (21 1/4"). Depth 310mm (12 1/4"). Adjustable to 445mm (17 1/2") at the rear.

091100361



1



2



FREEHAND TRAY WITH CARRY HANDLE



3

RETAIL PACKAGED
These products are supplied in retail packaging.



091100577 SHOWN



1 Homecraft Folding Walsall Trolley

With a sturdy steel frame and moulded plastic trays, this trolley can be quickly and easily folded away for transport or storage. The handles are angled to give improved grip and stability and are height adjustable between 875 and 1060mm (34½ and 41¾"). External width 480mm (18¾"). External depth 470mm (18½"). Size when folded 480x185mm (18¾x7½"). Length depends on how high it has been set. Weight 7kg.
081447671



2 Homecraft Economy Walsall Trolley

This trolley has a steel frame with angled handles to give improved grip and stability. The shelves have open sides for easy transfer of plates and dishes, and rubber castors give control on any floor surface. This model is available as standard or height adjustable and with 64mm (2½") or 102mm (4") castors. Height standard 888mm (35½"). Adjustable upper tray height 564 to 736mm (22¼ to 29").

Weight
081306133 Standard Castor (2½") 8kg
091100577 Adj. Large Castor (4") 9kg

Maximum load weight **25 kg** **55 lbs**



3 Homecraft Standard Walsall Trolley

A cream steel frame with white coated shelves for easy cleaning. The lower shelf is cut away and one end of each tray has been left without a lip to facilitate food transfer. The angled side rails create comfortable hand grips. Available with 102mm (4") castors. Height to handle 920mm (36"). Shelves are 445x305mm (17½x12").

Weight
091100551 Large Castor (4") 9.5kg

Maximum load weight **25 kg** **55 lbs**



4 Homecraft Adjustable Walsall Trolley

This trolley has the advantage of being adjustable to suit individual requirements. Both the handle and tray heights are adjustable to suit a wide range of user heights. It is supplied flat packed but is easily assembled without the use of tools. Available with 102mm (4") castors for greater manoeuvrability. Height to handle 889 to 1025mm (35 to 41"). Upper tray height 679 to 838mm (26¾ to 33"). Top shelf width x depth 450 x 450mm 17¾x17¾". Bottom shelf width x depth 450x450mm 17¾x17¾". Length 450mm 17¾". Weight 9.5kg.
091100585 Large Castor (4")



SPARES
 Spares are available for this product, for details and full spares listing please contact Customer Services.



1 Days Walker Trolley

This height adjustable walking trolley is a sturdy and robust walking aid for use within the home, providing a means of transporting items from one room to another. The Trolley includes clip-on plastic shelves and is easy to clean. There are rails on tray edges to prevent items slipping off and the lockable hand brakes provide additional safety when rising from a seated position. Overall Width 585mm (23"). Overall Depth 560mm (22"). Handle Height 755 to 905mm (29³/₄ to 35³/₄"). Wheel diameter 150mm (6").

081449230 Beige

091557289 White

Maximum user weight



2 Days Adjustable Height Plastic Shelf Trolley

This high quality trolley is height adjustable from 880-1005mm (34¹/₂×39¹/₂"). It has two plastic clip-on shelves, which measure 460×330mm (18×13") and can easily be removed for cleaning. Supplied either flat packed or fully assembled.

091438969 Flat packed

091435213 Fully assembled

Maximum user weight



1

Kitchen & Dining

2



SPARES

Spares are available for this product, for details and full spares listing please contact Customer Services.

1



homecraft

1 Homecraft Newstead Standard Trolley

These trolleys are made with an attractive beech finish with two cream coloured shelves. The lower shelf is cut away at the handle end to make walking with the trolley easier and safer. The far ends of the shelves are left without a lip to facilitate the transfer of items on or off the trolley. It has four swivel castors. Available with either small 31mm (1¹/₄") or large 102mm (4") castors. Height to handle 960mm (37³/₄"). Length 550mm (22"). Width 400mm (16"). Weight 8.3kg.

091100403 Small Castors (1¹/₄")

091100411 Large Castors (4")

Maximum load weight

15 kg	33 lbs
-----------------	------------------



2 Homecraft Newstead Compact Trolley

Similar to Newstead Standard Trolley but with shorter shelves. It has four swivel castors. Available with either small 31mm (1¹/₄") or large 102mm (4") castors. Height to handle 960mm (37³/₄"). Length 400mm (16"). Width 400mm (16"). Weight 7.3kg.

091100387 Small Castors - Assembled (1¹/₄")

091100395 Large Castors - Assembled (4")

Maximum load weight

15 kg	33 lbs
-----------------	------------------



2



homecraft

3



homecraft

3 Homecraft Newstead Dining Trolley

A version of the Standard Trolley, which can also be used as a table. The top shelf has no lip on one side to make it easier to slide plates and dishes on or off, and the lower shelf is cut away on the same side to make more space for the legs when sitting. Available with large 102mm (4") castors only. Height to handle 890mm (35"). Length 550mm (22"). Width 400mm (16"). Weight 5.8kg.

091100437 Large Castors (4")

Maximum load weight

15 kg	33 lbs
-----------------	------------------



4



4 The Buckingham Walking Frame Caddy

Developed by healthcare professionals to enable users of wheeled walking frames to safely transport a variety of daily living items. In most instances it can replace the need for a trolley. The caddy enables a user to carry most items safely and more importantly, independently without being reliant upon carers. With one large and one small compartment to allow the user to separate items such as glasses, keys, medication etc. Supplied with a tray that is designed to safely transport a plate of food, and a mug holder which holds any spillages. The caddy is easy to fit to most styles of walking frame. Manufactured from a tough, durable plastic it can be cleaned in a dishwasher and has drainage holes, for easy drying. Width without tray 434mm (17"). Width with tray 457mm (18"). Depth with tray 310mm (12¹/₄"). Height 200mm (8"). Total weight 1kg.

091117811

Maximum load weight

2 kg	4¹/₂ lbs
----------------	--



SPARES

Spares are available for this product, for details and full spares listing please contact Customer Services.